



INROLED_25

Slender, lightweight, discreet

The INROLED_25 was developed for hygiene-sensitive areas, such as the food industry or pharmaceutical industry, but is also used in other industrial areas. The LED luminaire fully complies with the requirements of the Food Safety Standard IFS 6. The INROLED_25 has a diameter of only 25 mm and can be installed easily and quickly.

The Technology

- Housing: Protective tube made of 2 mm thick, splinter-free polycarbonate with sealed end caps
- No dirt-collecting edges
- Hardly any heating, residual heat dissipation through ribbed internal aluminium base body
- FDA compliant materials; M12 plug connector made of stainless steel (F&B compliant) encapsulated in housing

Your benefits

- Flicker-free light without UV and IR components
- Wide spread and homogeneous light
- Very slender construction and extremely lightweight
- Luminaire can be freely positioned within the pivot range
- Resistant to hydrogen peroxide (H₂O₂, max. 35%), acids as well as alkaline solutions*

Areas of application

- Packaging industry, food and beverages, pharmaceuticals
- Machines, conveyor belts, architecture and buildings

Designs/installation

- 3 lengths: 348 mm, 552 mm, 952 mm
- Spring clamps for mounting and quick change
- Optional: Luminaire bracket made of F&B-safe V4A (stainless steel)

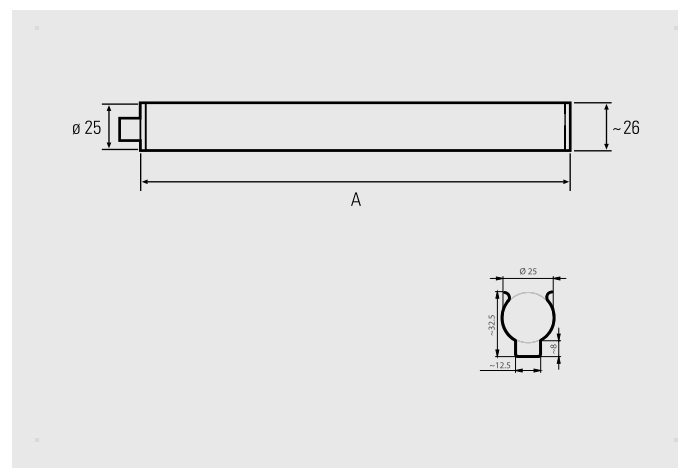

*Preliminary examination on a case-by-case basis



INROLED_25, 5200K-5700K	Product no.	Length (A)	Optics	$E_{average}^*$	E_{max}^*	Luminous flux	Output	Connection
INROLED_25	117010-01	348 mm	100°	81 lx	108 lx	approx. 300 lm	4.5 W	24V DC
INROLED_25	117110-01	552 mm	100°	133 lx	176 lx	approx. 500 lm	7.5 W	24V DC
INROLED_25	117210-01	952 mm	100°	218 lx	281 lx	approx. 875 lm	13 W	24V DC

Delivery incl. luminaire holders (retainer clips) for pivotable mounting

* Average and maximum lighting intensities, measuring area 100 cm x 100 cm at 100 cm distance

Accessories	Product no.
INROLED_25 luminaire holder, F&B-suitable, 1 pair	210200-10
INROLED_25 luminaire holder 1 pair cable ties + base, metal detectable PP	210200-13

Power supply, dimmboxes and connection material, see Accessories

